

Slanje zadatka nastavniku u Microsoft Teams - postojeći dokument

Prvo je potrebno ući u **Tim** u kom je nastavnik zadao zadatak.

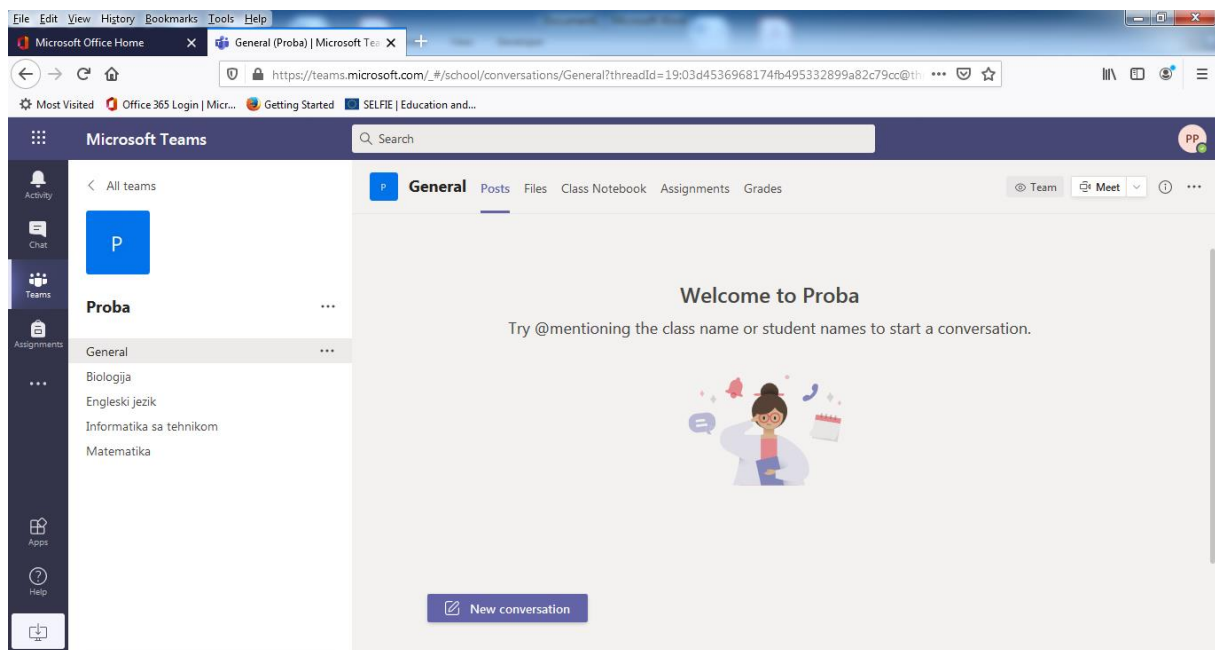

Obavještenje o novom zadatku se nalazi napr. u ovom slučaju u kanalu „**Informatika sa tehnikom**“,

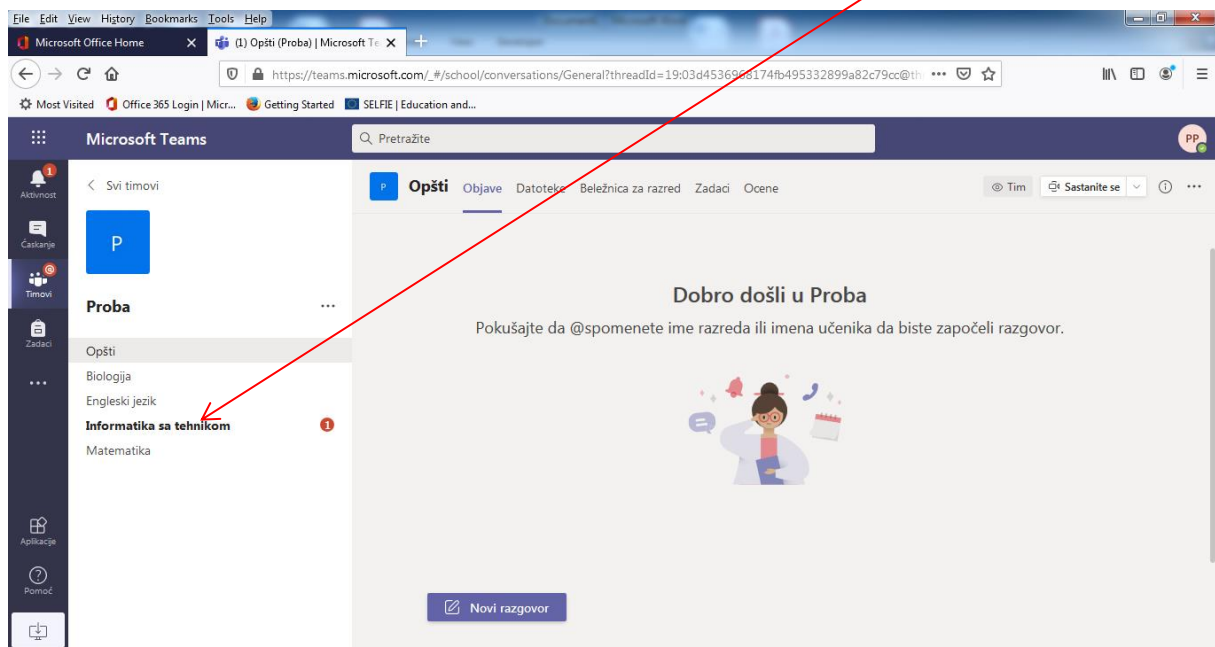

Klikom na kanal "Informatika sa tehnikom" otvara se zadatak

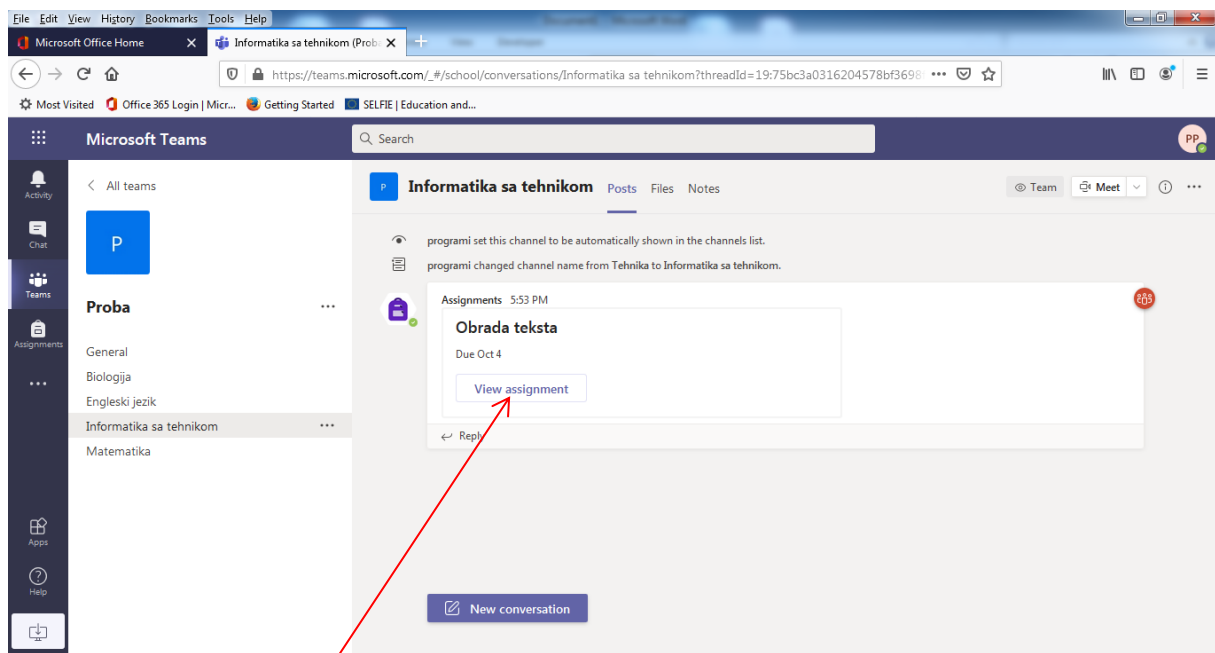

Zatim na **View assignment**, prikazuje se sadržaj zadatka:

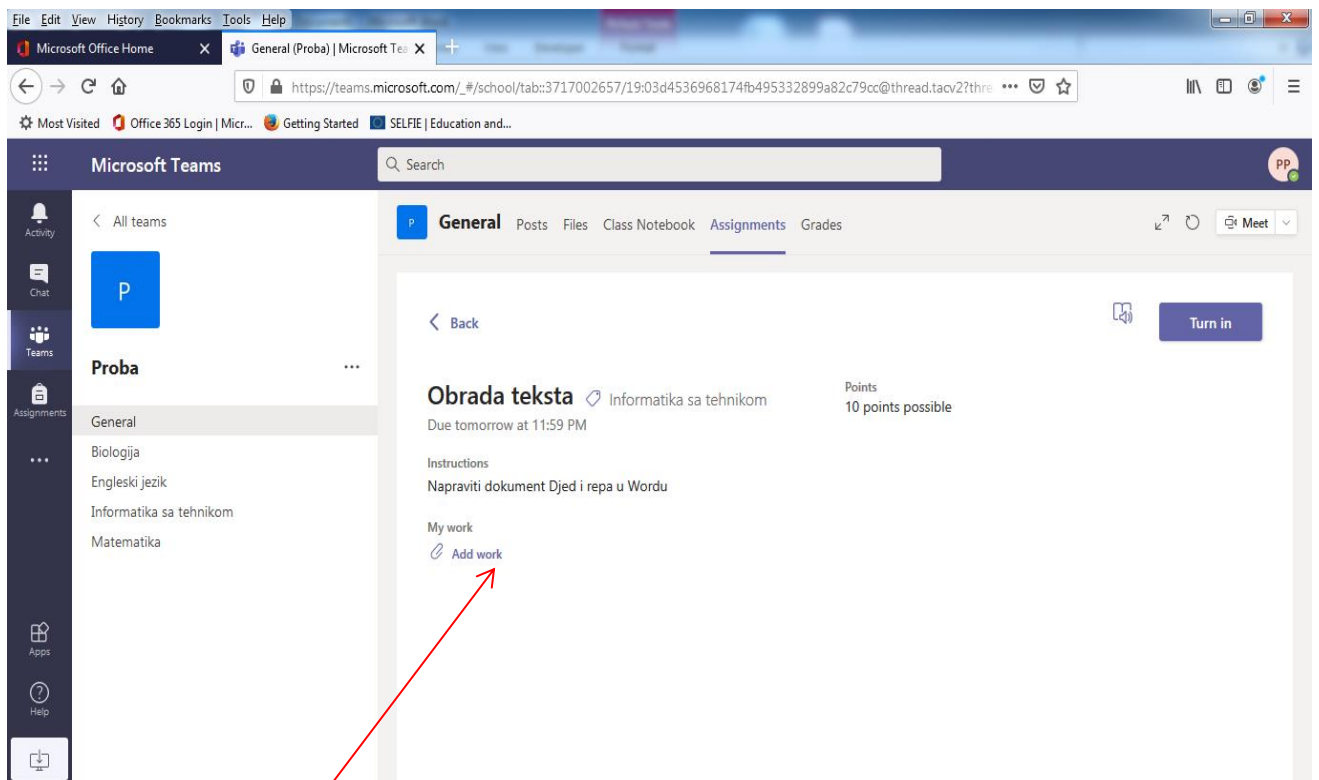

Klikom na **Add Work** (Dodaj posao) otvara se sledeći prozor:

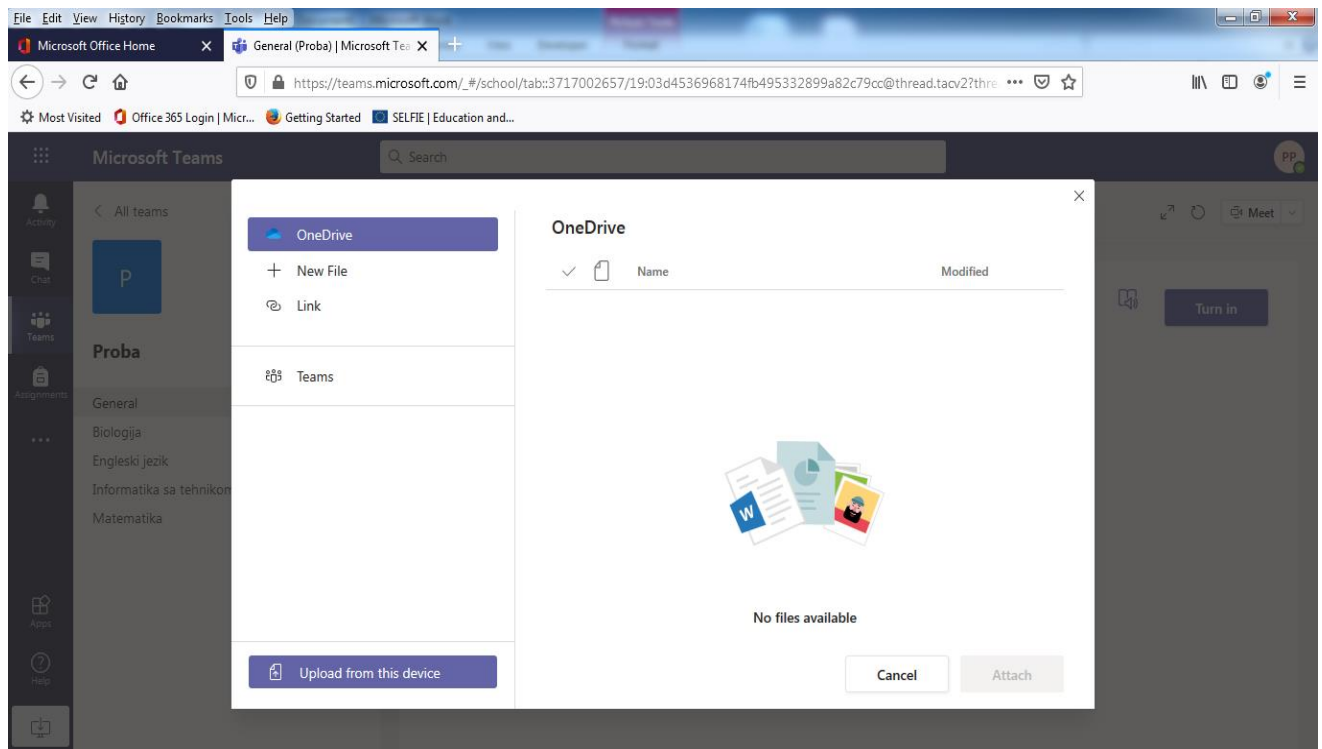

Ako je rad snimljen na računaru treba kliknuti na **Upload from this device** (otpremi sa ovog uređaja) i kliknuti na **Done** (gotovo)

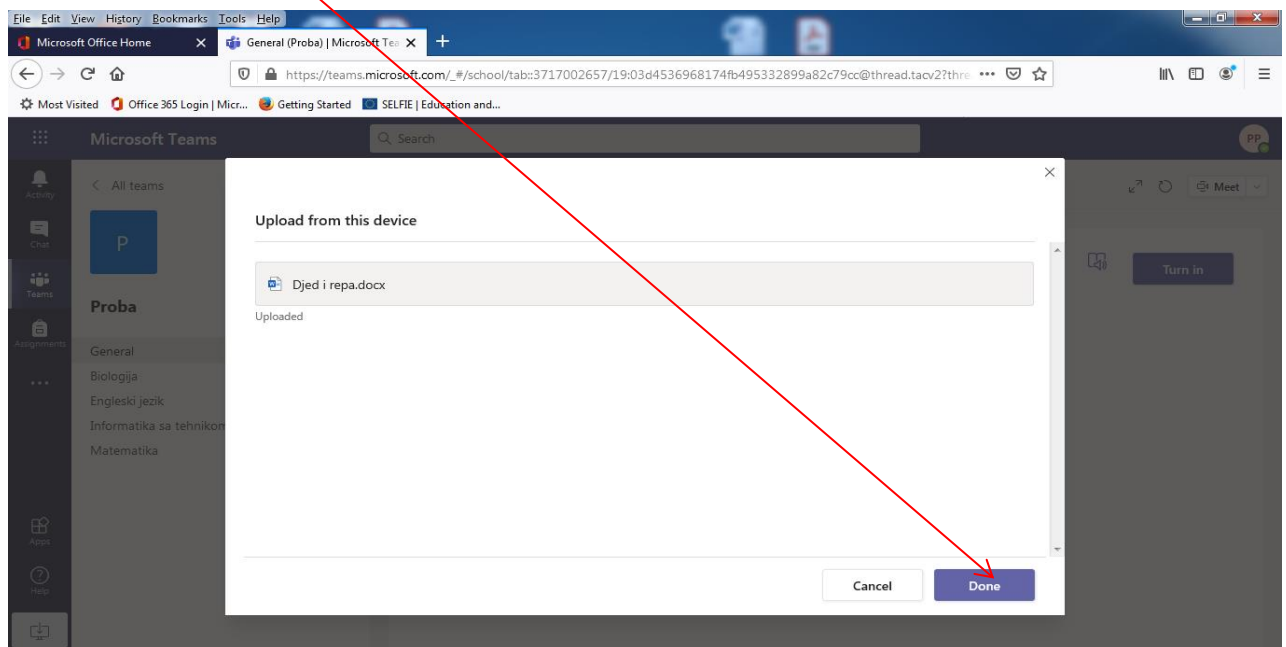

Kad je rad spreman za slanje nastavniku, šalje se klikom „Predavanje“.

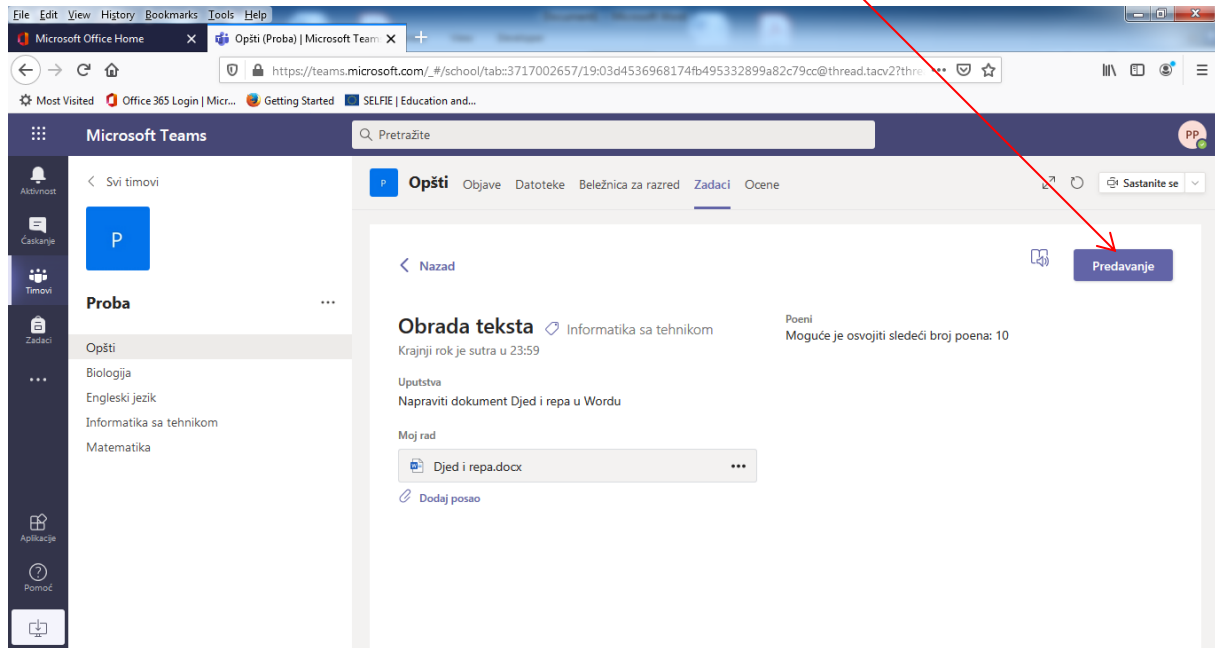

Kada pošaljemo rad dobija se ovaj izgled prozora

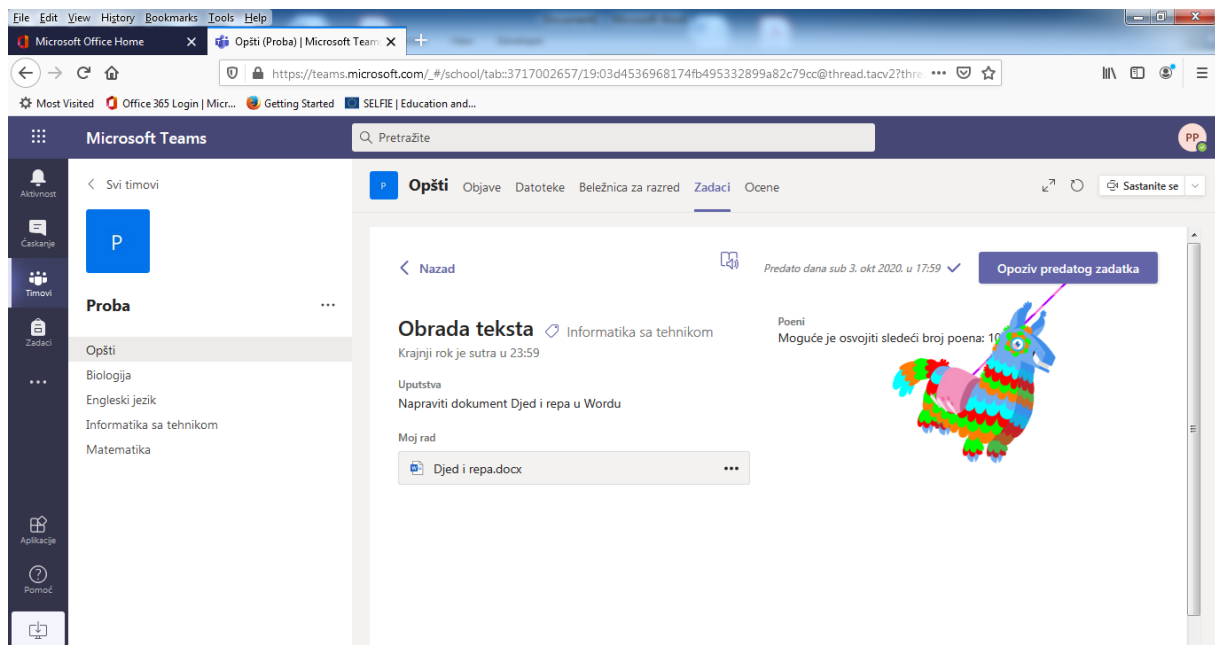

NAPOMENA

Proverite karticu **Aktivnost** kako ne biste propustili najnoviju dodelu zadataka

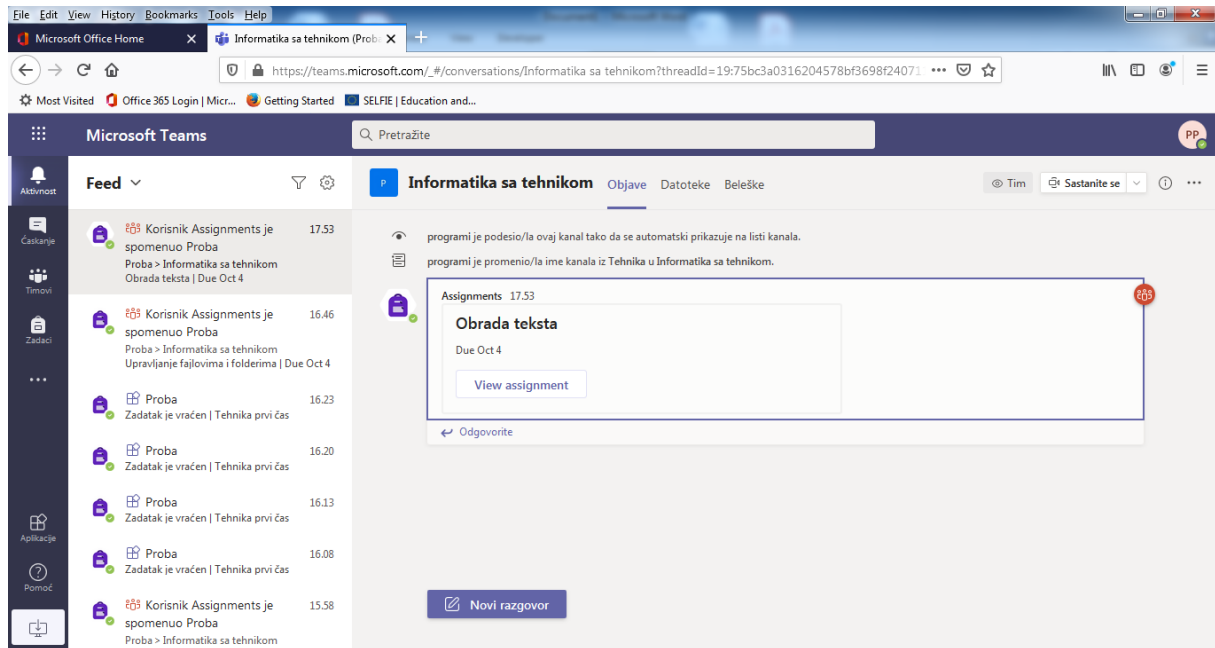

The screenshot displays the Microsoft Teams web interface. The top navigation bar includes the Microsoft Office Home logo and a search bar. The main content area is divided into a left-hand navigation pane and a central feed. The navigation pane on the left contains icons for 'Aktivnost' (Activity), 'Caskanje' (Calendar), 'Timovi' (Teams), 'Zadaci' (Tasks), 'Aplikacije' (Apps), and 'Pomoć' (Help). The central feed, titled 'Informatika sa tehnikom', shows a list of activity notifications. The most recent notification at the top is 'Korisnik Assignments je spomenuo Proba' with a timestamp of 17.53. Below this, there are several other notifications regarding assignments and tasks. A modal window is open over the feed, displaying an assignment card for 'Obrada teksta' (Text Processing) with a due date of 'Due Oct 4'. The card includes a 'View assignment' button and a 'Novi razgovor' (New Conversation) button at the bottom.

| Activity | Time |
|--|-------|
| Korisnik Assignments je spomenuo Proba | 17.53 |
| Korisnik Assignments je spomenuo Proba | 16.46 |
| Proba | 16.23 |
| Proba | 16.20 |
| Proba | 16.13 |
| Proba | 16.08 |
| Korisnik Assignments je spomenuo Proba | 15.58 |